

DRUM SHELVES WITH SUMP TRAYS TYPE SERIE 3000



Basic shelf 3000
+ Extension shelf 3001



Basic shelf 3002



Basic shelf 3004



Basic shelf 3006



Basic shelf 3010

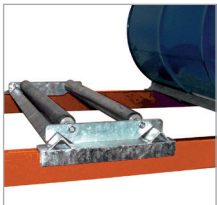

3013

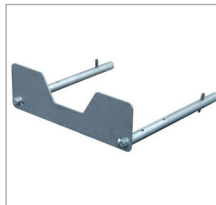

3014



- every unit tested for leakage
- flammable liquids, GHS categories 1 - 3
- hazardous to aquatic environment, GHS categories 1 - 4



3015



3016

- 3012 Clip-on rotating support for 1 x 60 litre drum
- 3013 Clip-on rotating support for 1 x 200 litre drum
- 3014 Retainer bar, galvanized
- 3015 Can Stand, galvanized
- 3016 Corner guard

Store drums horizontally or in an upright position and dispense from them. For max. 8 x 200 litre drums or 12 x 60 litre drums

- sump trays aus 3 mm Stahlblech
- with/without galvanized grid
- 100 mm ground leeway
- retention capacity 220 litres
- upright frame
- cross beams, powder coated
- drum supports for 60 or 200 litre drums, galvanized

Type	Max. no. of drums / position	Shelf (w x d x h) in mm	Sump tray (w x d x h) in mm	Weight in kg
3000	4 x 200 litre drums horizontal	1510 x 800 x 2000	1330 x 1200 x 260	134
3001	4 x 200 litre drums horizontal	1430 x 800 x 2000	1330 x 1200 x 260	117
3002	6 x 200 litre drums horizontal	1510 x 800 x 2500	1330 x 1200 x 260	159
3003	6 x 200 litre drums horizontal	1430 x 800 x 2500	1330 x 1200 x 260	138
3004	9 x 60 litre drums horizontal	1510 x 800 x 2000	1330 x 1200 x 260	170
3005	9 x 60 litre drums horizontal	1430 x 800 x 2000	1330 x 1200 x 260	153
3006	12 x 60 litre drums horizontal	1510 x 800 x 2500	1330 x 1200 x 260	202
3007	12 x 60 litre drums horizontal	1430 x 800 x 2500	1330 x 1200 x 260	182
3010	4 x 200 litre drums horizontal/4 x 200 litre drums upright	1510 x 800 x 2500	1330 x 1200 x 260	170
3011	4 x 200 litre drums horizontal/4 x 200 litre drums upright	1430 x 800 x 2500	1330 x 1200 x 260	161

Finish:

Sump trays hot-dip galvanized

Upright frames similar to RAL 5010

Cross beams similar to RAL 2004